

AROMA²⁴₇

Scent Trio

PRODUCT MANUAL

Aroma diffuser

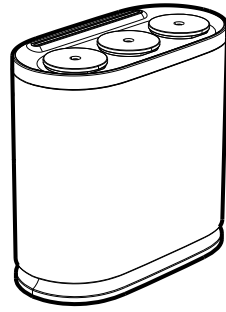

APP

01 Specification

- [Model] A309
- [Size] 246*230*121mm
- [N.W.] 2.245kg
- [Input] DC12V 1A MAX
- [Power] 12W
- [Coverage] 500m²/1500m²/55000ft²
- [Bottle] 120ml*3
- [Material] Plastic

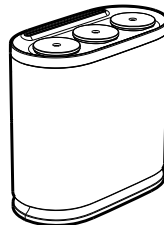

Machine Power cord User manual Bottle x3 Bottle cap x3

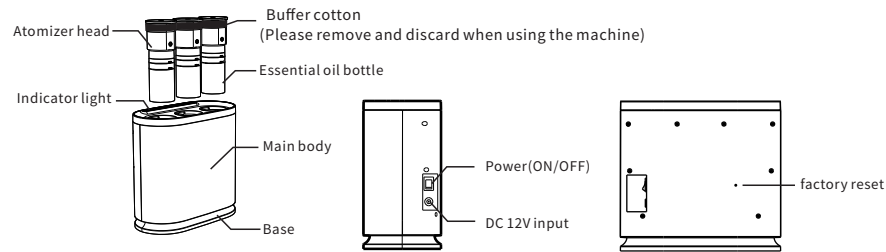

Indicator light: Three indicator lights correspond to three separate atomizers. While light is on, the atomizer is active.

02 APP instructions

Search AROMA 24/7 in Google Play or App Store

NOTE

1. Please make sure the bluetooth function is turned on
2. Please make sure the location of the mobile phone is turned on



Consumption: This value is calculate based on one hour of continuous machine work with 13 mPa.s aroma oil of our company. But aroma oils with different viscosities have varied consumption rates, you can calibrate it via app.

Aroma oil: The amount of aroma oil added to bottle.

Remaining: This refers to how long the aroma oil can be used based on consumption, aroma oil, grade, and working periods.

Turn ON/OFF the fan
Turn ON/OFF the fan

Calibrate: It is used for calibrating consumption. It is advised to calibrate after working for at least 10 days. Please measure the remaining oil of bottle first, then tap "calibrate" in the APP, input the amount of remaining oil, and confirm. So the consumption, remaining day, and percentage will be updated.

Timing switch, left slide to delete

Amend password

Slide up and down to adjust

Select the day

Select grade

If you forget the password, please press the reset button to restore the factory setting. The factory settings password is 8888.

If you forget the password, please press the reset button to restore the factory setting. The factory settings password is 8888.

03 OperationStep

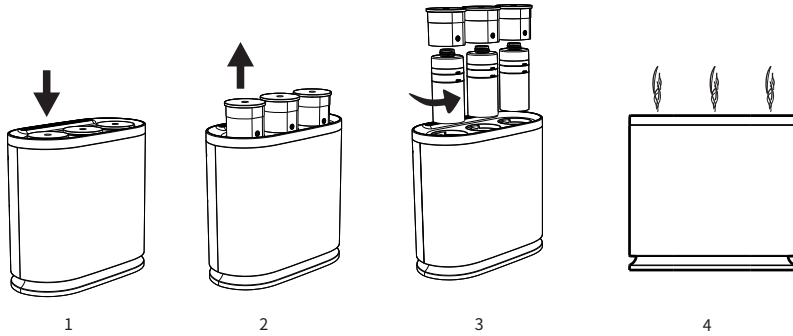

1. Press down the atomizer head, it will instantly pop up.
2. Pull the atomizer head up.
3. Screw bottle tightly and place back into the machine.
4. Plug AC adaptor into power jack, and press the power button to turn the power on, then connect to the Bluetooth to operate the machine.

04 Concentration&Consumption

Grade	working(s)	stop(s)	Consume(ml/h)
G1	5s	240s	0.058
G2	5s	220s	0.222
G3	10s	200s	0.307
G4	15s	180s	0.344
G5	20s	160s	0.442
G6	25s	120s	0.549
G7	30s	100s	0.645
G8	35s	80s	0.711
G9	35s	60s	0.881
Customized	5-35s	60-600s	

Note: The data shown above is only for reference, and it is normal for consumption to fluctuate by 15%.

05 ⚠ Warning

- ⊘ Shall not modify, disassemble or repair the machine if you're not a technician. Any failure happens, please contact relevant technician in time.
- ⊘ Avoiding get fire or electric shock, the power cord shall not be damaged, forced to be bended, yanked or under pressed by heavy objects, clipped or reprocessed.
- ⊘ Avoiding electric shock/ short out/ get fire any failures:
 - Shall not use the AC plug when it is damaged or un-matched with the socket;
 - Shall not wet the machine or the AC plug;
 - Shall not use overladen power socket, wire or broken plug.
- ⊘ Avoiding electric shock, shall not touch the wire or product shell when thundering or/and lightening.
- ⊘ Avoiding any abnormal conditions and damages, shall not disassemble the machine during operating.

1. After installation, please keep the machine vertical. Tilt or lie flatly may cause oil overflow. The machine efficiency may be affected if the circuit board is contaminated.
2. Shall not modify, disassemble or repair the machine arbitrarily. Any failure happens, please contact relevant technician in time.
3. When the machine is out of the working period, the display is still on but the machine stops working.
4. It is invalid to touch/tap button when machine is under lock status. No light or display on the screen.

06 Caution

The machine needs to be cleaned when below situations happen:

1. You're about to change to another essential oil;
2. The atomization volume becomes weak.

Cleaning steps:

1. Find a clean bottle and fill it with industrial alcohol.
2. Install this bottle to the machine and turn the machine on. Let it work for 5-10 minutes.
3. Turn off the electric, finish the cleaning.

07 Troubleshooting

Before asking to have the machine repaired, please try to diagnose the problem first based on the following instructions.

Symptom	Remedy
Does not diffuse	-Check the power is on or off ; -If the machine is in "not working period", it stops diffuse; -The pump is damaged, replace with a new one.
Spray little	-Atomized nozzle may be blocked, diffuse with alcohol to do cleaning ; -Pump is aging, replace with a new one.
Spray liquid	-Atomized nozzle is damaged, replace with a new one. -Machine is tilted or lay flat, please make it stand upright.
Oil spill	-Bottle is loose, screw it to the right place.
Abnormal sound	-Pump is loose, install it correctly.